

NBI INSTALLATION GUIDELINES

Please read all instructions carefully before beginning installation!

PLEASE NOTE: All NBI DRAINBOARDS sinks are designed so that the drainboard sections do not interfere, require contact, or require cutout areas to be made to the countertop surfaces below them. The only cutout required to facilitate a proper installation would be to accommodate the sinks basin or basins. While not required, the following instructions will remove the sections of countertop below the drainboards. If you prefer not to make these additional cutouts below the drain boards, **you may** locate and position the cutout lines for the basin or basins only.

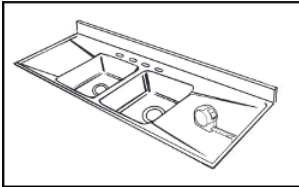

STEP 1: Measure the sinks overall dimensions (length and width) and make note of these measurements.

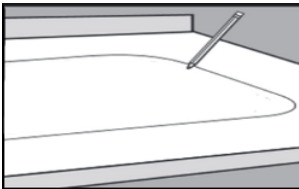

STEP 2: Using tape lines or crayon, transfer the dimensions you noted in **Step 1** onto the countertop surface, positioning and aligning them in the desired location of the installed sink. These markings should now represent the sinks outer perimeter edges. **Cautionary Note: Make sure to radius all corner markings as necessary and verify your dimensions and markings!**

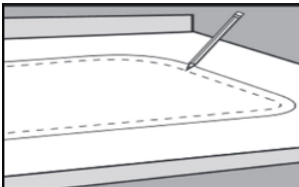

STEP 3: Measure in 1 ¼" and draw new lines inside the sinks dimensional lines that were made in **Step 2** above.

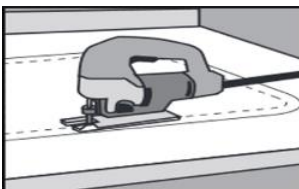

STEP 4: Cautionary Note: Verify all dimensional lines before proceeding! Following the inner line that was drawn in **Step 3** carefully cutout the countertop surface.

STEP 5: Temporarily position the sink in the countertop opening to ensure a proper fit. Make small adjustments to the cutout if necessary, making sure never to cut beyond the outer lines that were drawn in **Step 2**.

STEP 6: Carefully remove the sink and clean the countertop surface removing any tape that may have been used.

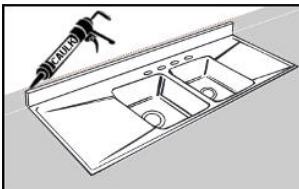

STEP 7: Place the sink back into the countertop opening and position it in its final location. Apply a continuous bead of the appropriate colored (we recommend the sinks finish color be used) kitchen & bath adhesive sealant around the entire perimeter of sinks flange where it meets the countertop surface. Remove and cleanup excess sealant and allow curing time per the sealant manufacturer's recommendation.

STEP 8: Make all remaining plumbing connections per local code and/or to the manufacturer's recommendations.